



SX83



TYPICAL APPLICATIONS Small appliances

FUNCTIONS

- Double SPST, illuminated or not
- Double SPDT
- SPST, illuminated or not + Indicator light
- SPST + SPCO

CYCLE No. 50.000

CUT OUT 30x22 mm

AMBIENT TEMPERATURE 125 °C

GWT 850 °C

GWT NO FLAME (<2sec) 750 °C on demand

S X 8 3

DRAWING

?

TERMINAL

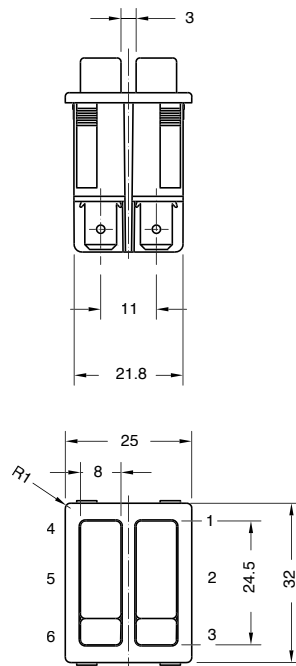

1

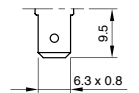

P (1 + waterproof cap mounted)

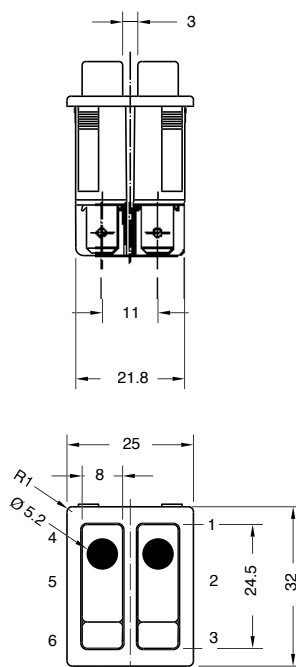

3

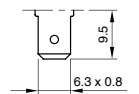

Q (3 + waterproof cap mounted)

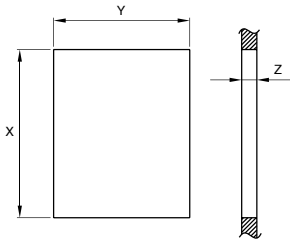

| | Z | Y | X |
|---------|-------------|---------|-----------------------------------|
| PLASTIC | 0,7 ... 3,5 | 22 ±0,1 | 30 ^{+0,2} ₀ |
| METAL | 0,7 ... 2,5 | 22 ±0,1 | 30,2 ^{+0,2} ₀ |

| TERMINAL | FUNCTION | RATING | BODY COLOUR | ROCKER COLOUR L | ROCKER COLOUR R | MARKING COLOUR | MARKING L | MARKING R | LENS COLOUR |
|----------|----------|--------|-------------|-----------------|-----------------|----------------|-----------|-----------|-------------|
| S | X | 8 | 3 | | | | | | |

| ? | ? | ? | L ? R ? | ? | L ? R ? | ? |
|----------|--------|-------------|---------------|----------------|---------|-------------|
| FUNCTION | RATING | BODY COLOUR | ROCKER COLOUR | MARKING COLOUR | MARKING | LENS COLOUR |

| | |
|---|---|
| 0 | 0 |
|---|---|

1

8

Function 1
 20 (2) A / 250 VAC
 16 (8) A / 250 VAC
 10 (4) A / 400 VAC
 10 (6) A / 250 VAC - 5E4
 T125/55 °C
 EN 61058

1 black

2 white

X custom

1 black

2 white

0 none

1 black

2 white

X custom

0

0 none

3

20 A / 125 VAC
 16 A / 250 VAC
 3/4 HP - 125 / 250 VAC
 T105 °C
 UL 1054

X custom

ILLUMINATED

G red

H orange

E green

1

1

ILLUMINATED

G red

H orange

E green

X custom

6

20 A / 125 VAC
 16 A / 250 VAC
 3/4 HP - 125 / 250 VAC
 T105 °C
 UL 1054

X custom

X custom

4

D

E

H

N

X

F

Function W - 6
 20 (2) A / 250 VAC
 16 (8) A / 250 VAC
 10 (6) A / 250 VAC - 5E4
 T125/55 °C
 EN 61058

20 A / 125 VAC
 16 A / 250 VAC
 3/4 HP - 125 / 250 VAC
 T105 °C
 UL 1054

K

Function R
 20 (2) A / 250 VAC
 16 (8) A / 250 VAC
 10 (6) A / 250 VAC - 5E4
 T125/55 °C
 EN 61058

R

Function 6 - F
 20 (2) A / 250 VAC
 16 (8) A / 250 VAC
 10 (6) A / 250 VAC - 5E4
 T125/55 °C
 EN 61058

W

16 A / 250 VAC
 3/4 HP - 250 VAC
 T105 °C
 UL 1054

Function K
 16 (6) A / 250 VAC
 10 (4) A / 250 VAC - 5E4
 T125/55 °C
 EN 61058