

# 30 CVEREL

THE WORLD IN A CLICK

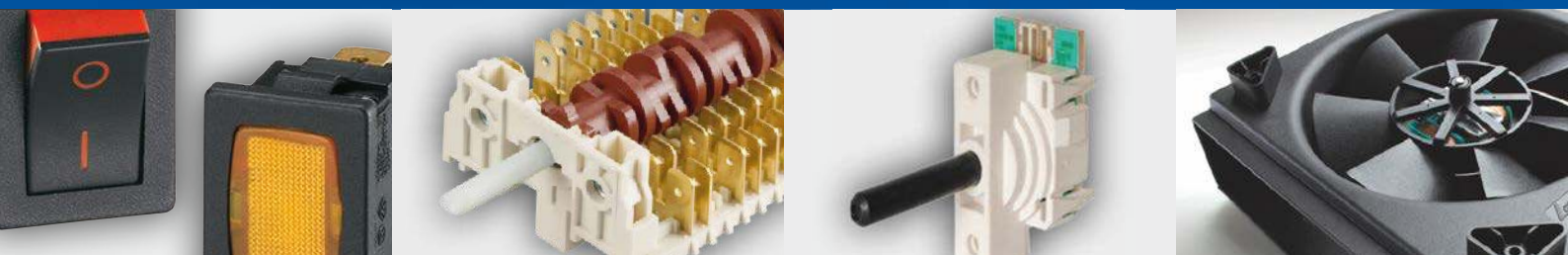

## SELECTORS



**Dreefs**

 **SIGNAL LUX**

**givem**

**M MOLVENO**

 **KAUTT & BUX**

# Selectors

04

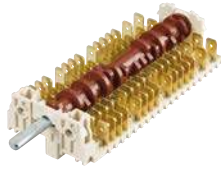

**HE**

176

---



**5HE 7TAKT**

180

---

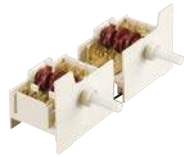

**5HE 7TAKT DUO**

182

---



**HT**

184

---

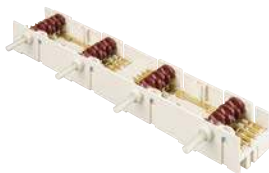

**5HE 4 BLOCK**

186

---

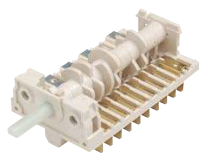

**CH**

187

---



**2CH WITH ENCODER**

188

---

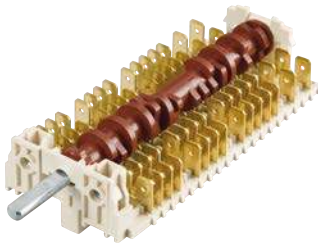

# HE



<b>TYPICAL APPLICATIONS</b>	Function selector switch
<b>WIRING DIAGRAMS</b>	2 - 14 positions Rast 5 connectors
<b>GWFI</b>	850 °C
<b>GWIT</b>	750 °C

Rotary switches with a wide range of configurations. 6 types of housing available, different for the maximum number of contacts. HE series is automatically assembled in a great variety of configurations.

- Function selector switch
- Child lock - push to turn feature on demand
- Coupling with encoder available
- Flexibility of wiring diagrams
- Different "click" or frictional feeling
- Metal or plastic shafts with different lengths: 12,5 - 46 mm (standard shafts protude: 23 mm)

### EXAMPLE OF 11HE WITH 8 CONTACTS

Easy wiring with multiple plug (Rast 5) or single terminals 6,3 mm

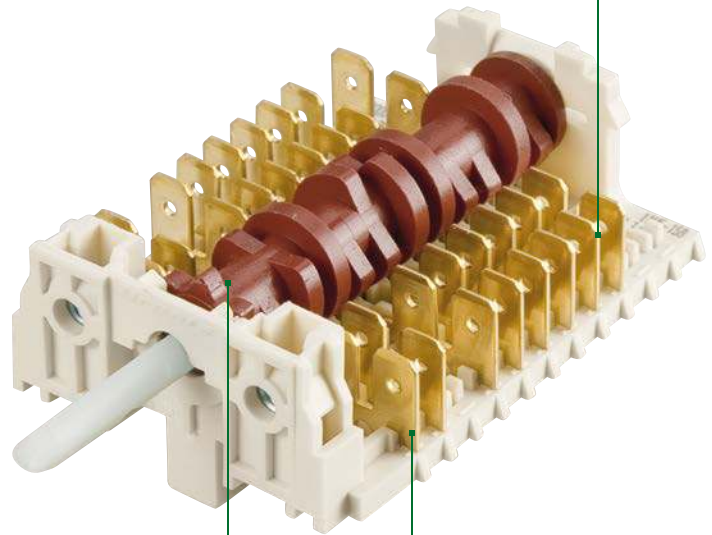

2 - 14 positions

Standard double contact

#### Rating

16 A / 250 VAC - 10E3  
 12 A / 400 VAC - 30E3  
 0,25 A / 250 VAC - 30E3  
 T150 °C  
 According to  
 EN61058-1 standard

16 A / 250 VAC  
 T120 °C  
 According to  
 UL 1054

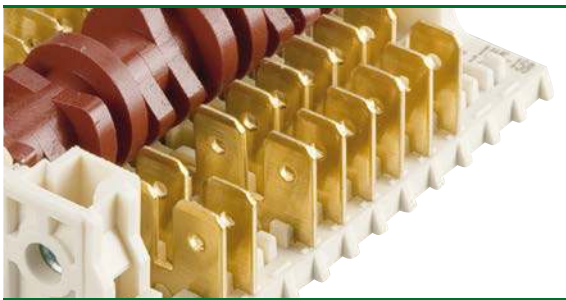

#### TYPICAL TERMINALS

- Single terminals
- Double terminals
- Chopped
  - left
  - center
  - right

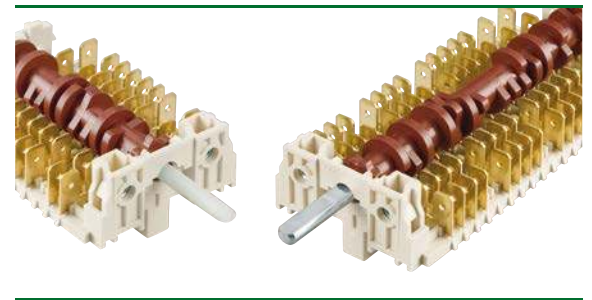

#### TYPES OF SHAFT

Plastic

Metal

## DIMENSIONS

### Standard version

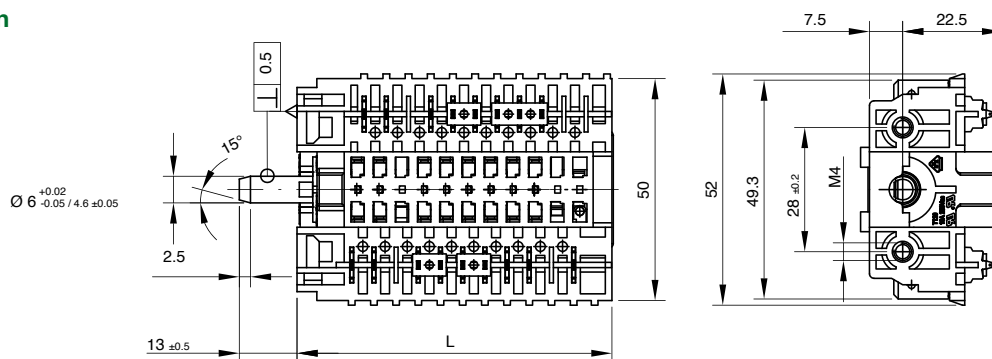

### Thermostat version

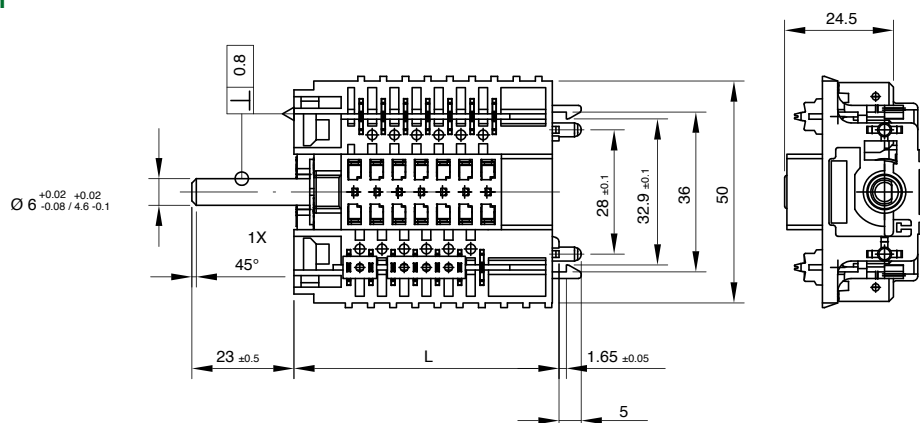

## TECHNICAL FEATURES

Version	No. contacts	Length	
		L	L thermostat version
3HE	up to 3	30	38
5HE	up to 5	40	48
7HE	up to 7	50	58
11HE	up to 11	70	78
15HE	up to 15	90	98
19HE	up to 19	110	118

## OPTIONS

Higher number of contacts, multiple versions, possibility to use accessories are the main features of HE series.

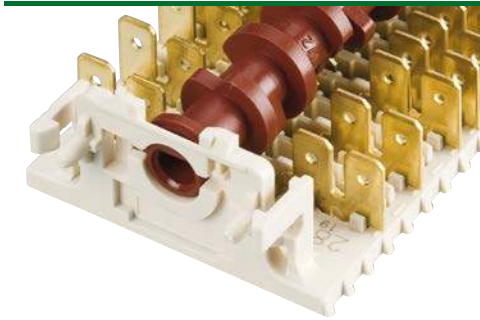

### Body with accessory holder

- Possibility to use in conjunction with a capillary thermostat or an encoder

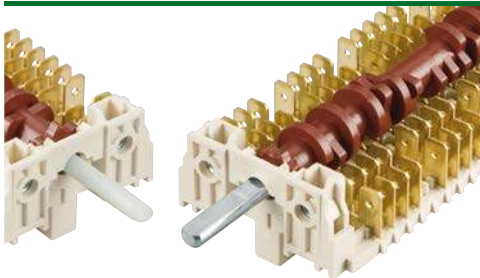

### Shaft

- Metal or plastic shaft with length on demand (12.5 - 46 mm)
- Standard shaft length: 23.5 mm

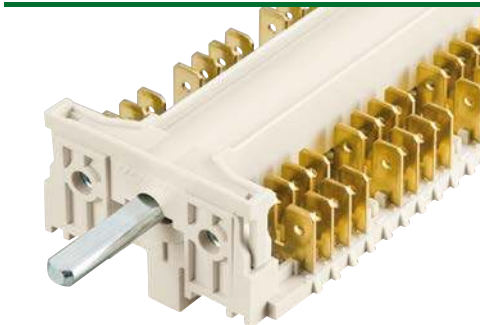

### Cam cover

- Cam cover protects cam and contacts from dirt and waste of cooking.
- Note: cam cover is available for 11 and 19 versions.

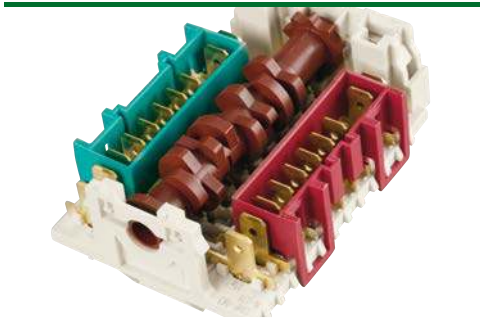

### Terminal housing

- Various dimensions of terminal housing: for 2 - 4 - 6 connections.
- Terminal housing available only for single terminal version.



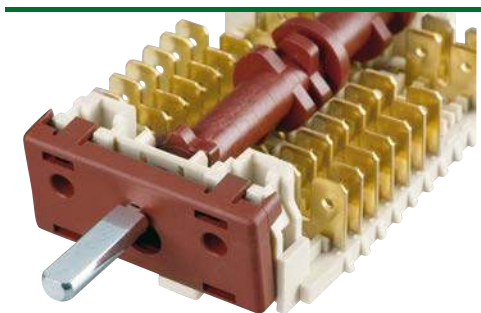

#### Child lock - push to turn feature

- Push to turn safety feature available.

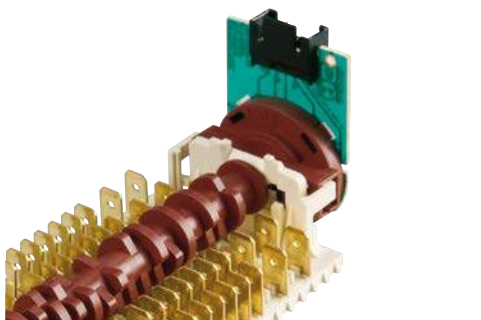

#### Coupling with encoder

- HE series can be coupled to an electromechanical to control electrical and power signals.

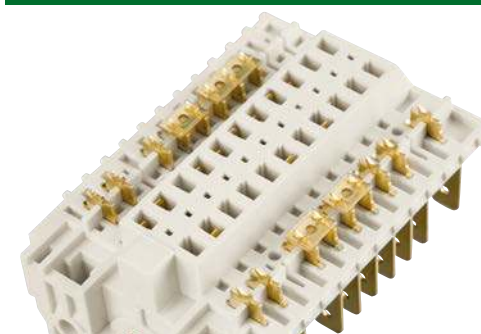

#### Bridges

- The use of bridges between contacts increases range of combinations.
- For every line the number of bridges can vary between 0 up to 5.
- It can be joined up to 7 contacts.

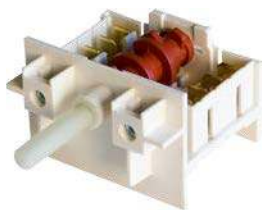

# 5HE 7TAKT



On demand

<b>TYPICAL APPLICATIONS</b>	Hobs control
<b>WIRING DIAGRAMAS</b>	7 positions
<b>GWFI</b>	850 °C
<b>GWIT</b>	750 °C

Rotary switches with different mounting solution available, 7 positions, with electric rating up to 12A. Ideal for hobs control, with a terminal housing conjuncted to the body.

- Standard connecting with single terminals 6,3 mm
- Different mounting solutions available:  
snap-in, nuts or screw fixing
- 30.000 cycles
- Plastic shafts with different lengths (16 - 31 mm)

#### Rating

12 A / 400 VAC 30E3

T150 °C

According to

EN61058-1 standard

16 A / 250 VAC

T120 °C

According to

UL 1054

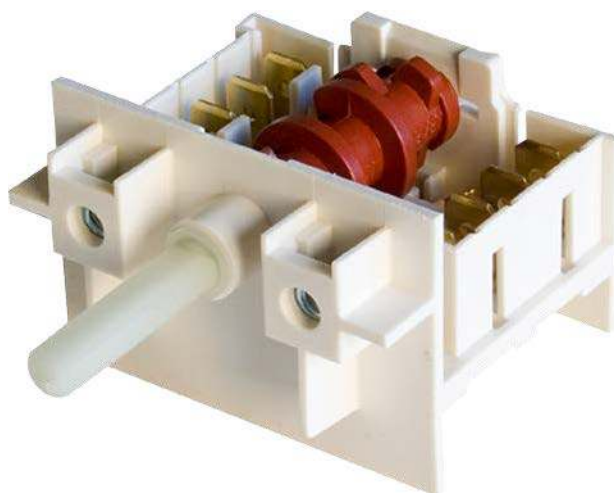

#### TECHNICAL FEATURES

Rast 6,5 multiple connection.

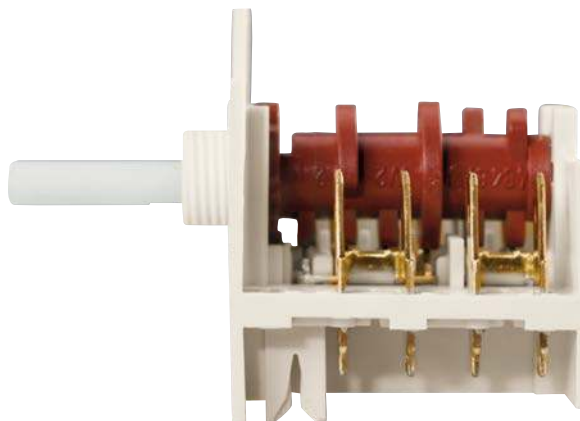



## DIMENSIONS

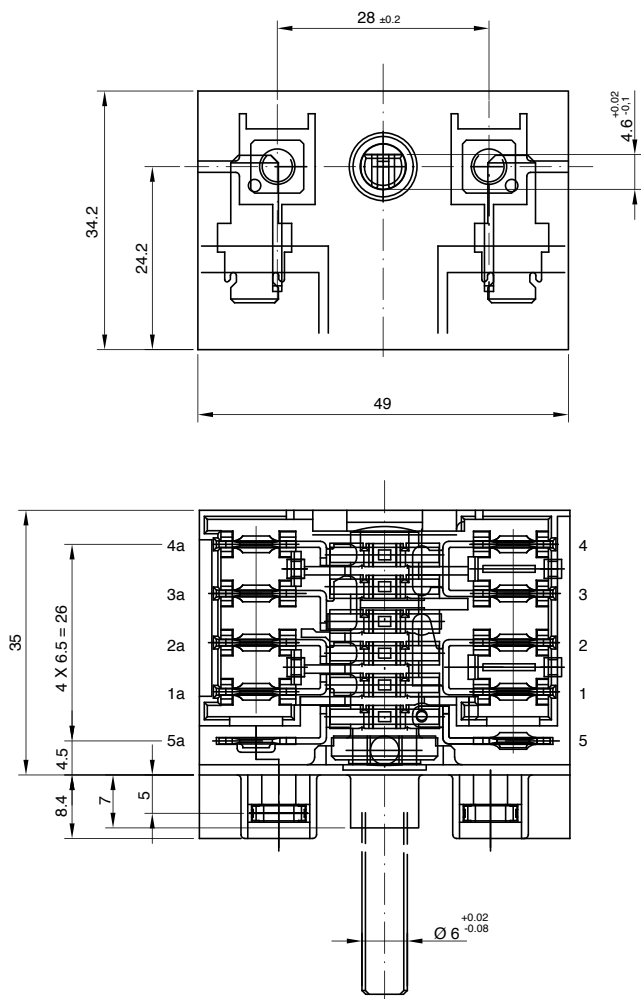

## CONTACT SEQUENCE

Pos.	Ang.	P3		P1		P2	
		5a	1a-2a	1a-2a	3a-4a	3a-4a	3a-4a
		5	1	1	3-3	4	
		5	2	2	3-3	4	
0	0°						
1	51,4°	■	■	■		■	■
2	102,8°	■		■		■	■
3	154,2°	■		■		■	
4	205,6°	■		■			■
5	257,0°	■			■		■
6	308,4°	■	■			■	

## SOLUTIONS

### Nut Fixing



### Screw fixing

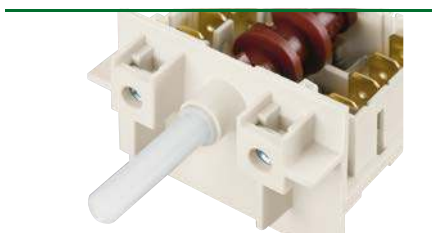

### Snap-in fixing

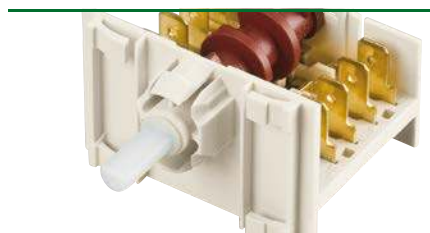

## CUT OUT

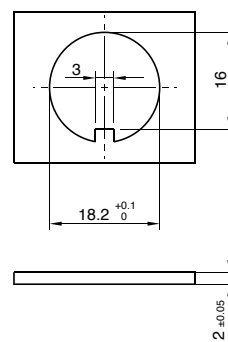
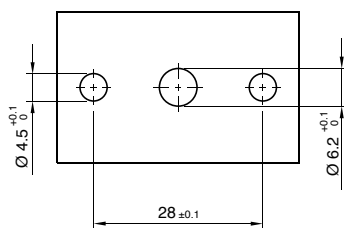
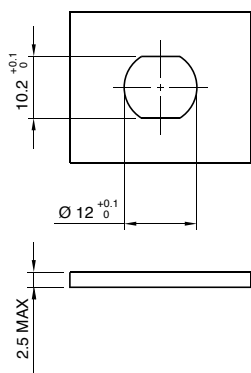

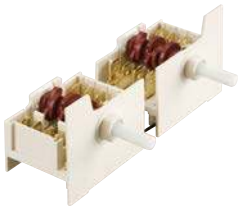

# 5HE 7TAKT DUO



<b>TYPICAL APPLICATIONS</b>	Hobs control
<b>WIRING DIAGRAMAS</b>	7 positions
<b>GWFI</b>	850 °C
<b>GWFI</b>	750 °C

This series is composed of two 5HE 7TAKT rotary selectors, 3 different distances of axis available (55, 60 and 65 mm). Each selector has 7 positions, electric rating up to 12A and different mounting solutions. Duo block permits to make the wiring easier.

- Standard connecting with single terminals 6,3 mm
- Different mounting solutions available: snap-in, nuts or central mounting
- Metal or plastic shafts with different lengths
- Rast 6,5 multiple connection available
- Metal or plastic shafts with different lengths:  
(16 - 31 mm)

## EXAMPLE OF 5HE 7TAKT DUO WITH NUTS

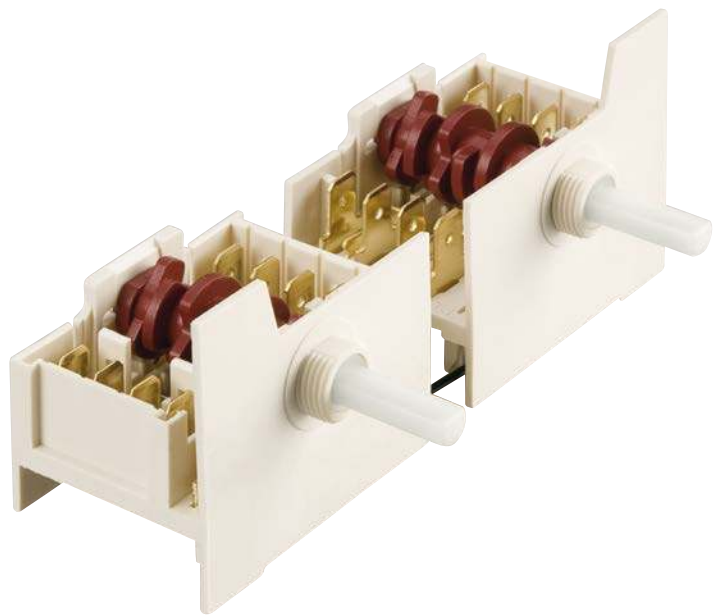

**Rating**  
12 A / 400 VAC 30E3  
T150 °C  
According to  
EN61058-1 standard

16 A / 250 VAC  
T120 °C  
According to  
UL 1054

## TECHNICAL FEATURES

Various distances of axis available:  
55, 60 and 65 mm.

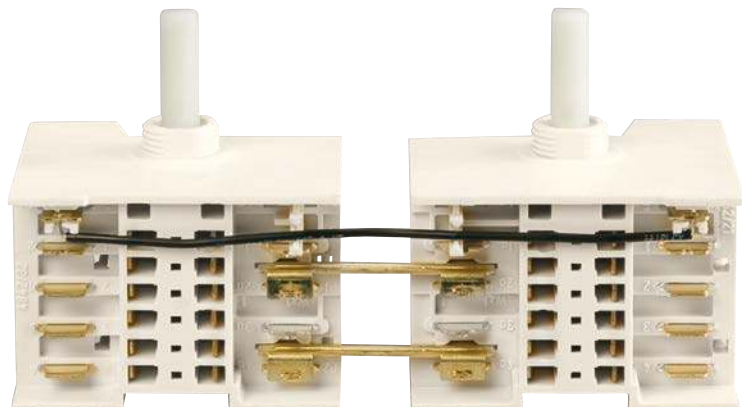

## DIMENSIONS

Screw fixing version

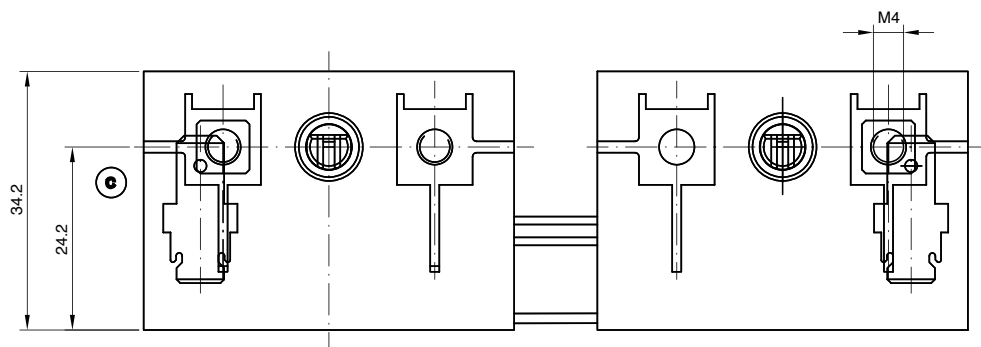

60 mm interaxis version  
(55 and 65 mm available)

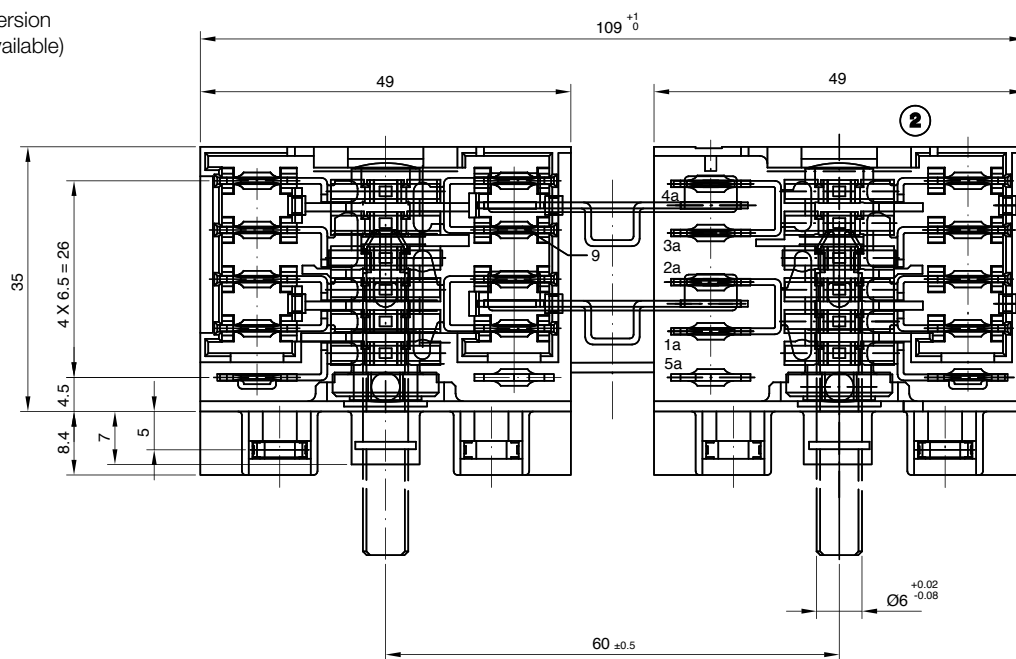

## CONTACT SEQUENCE

		P3	P1		P2									
	Ang.	5a	1	2	3-3	4		Pos.	Ang.	5a	1a-2a	3a-4a		
Pos.		S								S	1	2	3-3	4
0	0°							0	0°					
1	51,4°	■	■	■		■	■	1	51,4°	■	■	■		■
2	102,8°	■		■		■	■	2	102,8°	■		■		■
3	154,2°	■		■		■	■	3	154,2°	■		■		■
4	205,6°	■		■		■	■	4	205,6°	■		■		■
5	257,0°	■			■		■	5	257,0°	■			■	■
6	308,4°	■	■			■	■	6	308,4°	■	■		■	



# HT

<b>TYPICAL APPLICATIONS</b>	Electric hobs in freestanding cookers
<b>WIRING DIAGRAMAS</b>	2 standard positions rotary switch
<b>GWFI</b>	850 °C
<b>GWIT</b>	750 °C



7 positions rotary switch, ideal for electric hobs in freestanding cookers. M4 screw mounting and different shafts available. Special sequences with 4 - 5 - 6 positions are available.

- Terminals 6,3 mm
- M4 screw mounting
- Metal or plastic shafts
- With or without signal contact

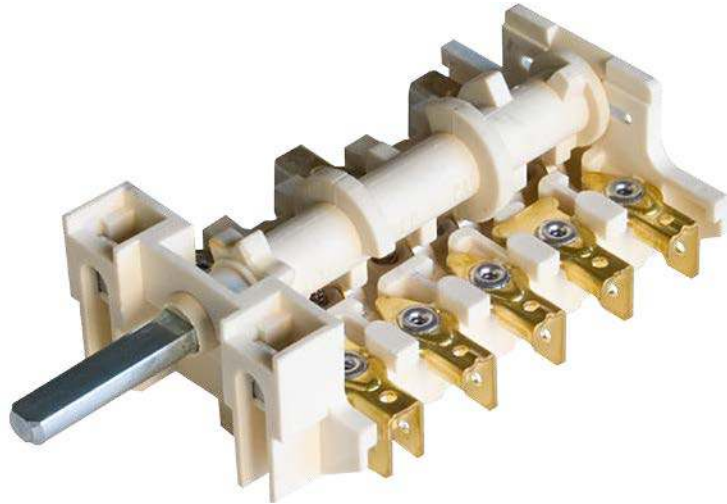

#### Rating

12 A / 400 VAC - 30E3

T150 °C

According to

EN61058-1 standard

16 (6) A / 250 VAC

T150 °C

According to

UL 1054

#### OPTIONS

Metal or plastic shaft, with length on demand.

Metal shaft

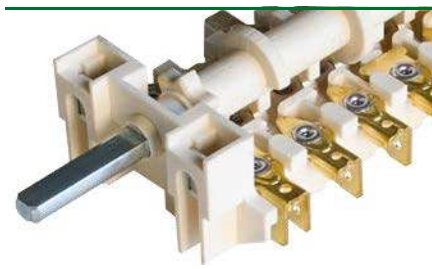

Plastic shaft

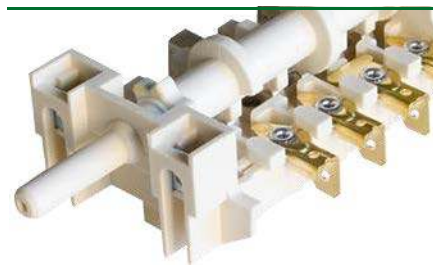

## DIMENSIONS

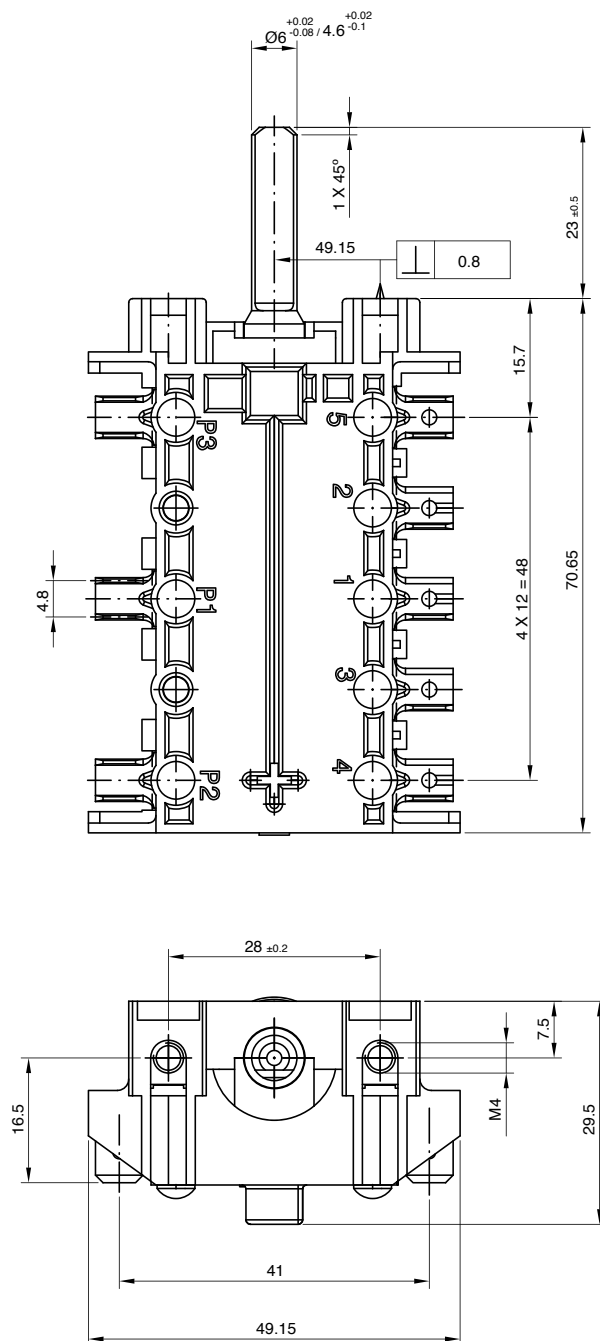

## EXAMPLE OF CONTACT SEQUENCE

Pos.	Ang.	5	2	1	3-3	4
		P3		P1		P2
0	$0^\circ$					
1	$51,4^\circ$	■	■	■		■
2	$102,8^\circ$	■	■			■
3	$154,2^\circ$	■	■			
4	$205,6^\circ$	■	■			■
5	$257,0^\circ$	■			■	■
6	$308,4^\circ$	■		■		■

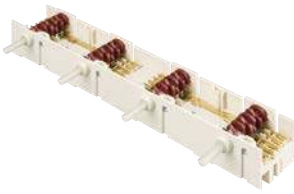

# 5HE 4 BLOCK



On demand

<b>TYPICAL APPLICATIONS</b>	Hobs control
<b>WIRING DIAGRAMAS</b>	7 positions
<b>GWFI</b>	850 °C
<b>GWFI</b>	750 °C

This solution integrates all wirings of four 5HE 7TAKT in a single body; robustness, compactness and easy mounting are its best features.

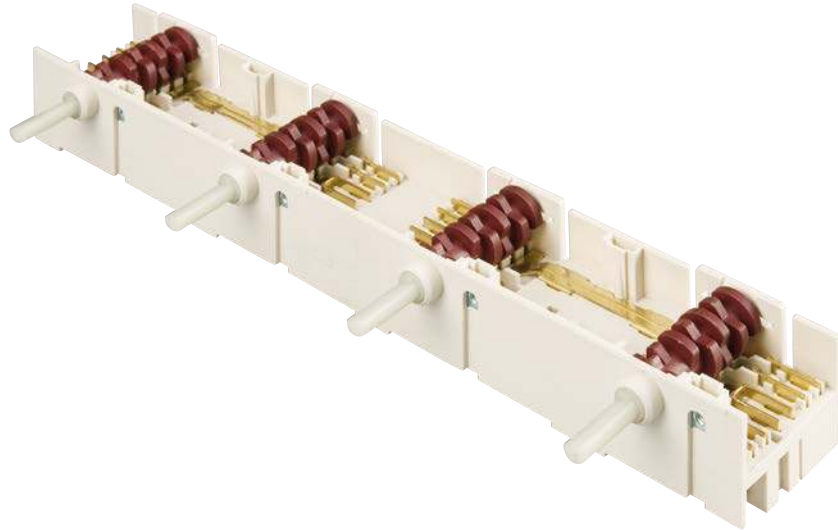

**Rating**  
12 A / 400 VAC - 30E3  
T150 °C  
According to  
EN61058-1 standard

16 A / 250 VAC  
T120 °C  
According to  
UL 1054

## DIMENSIONS

### 2 versions:

L = 247.35  
D = 65 ±0.2

L = 230.45  
D = 60 ±0.2

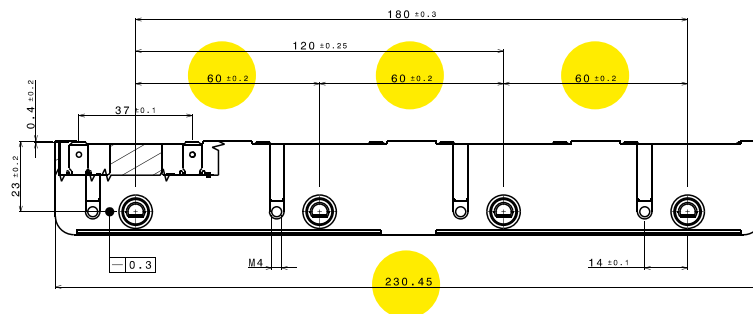
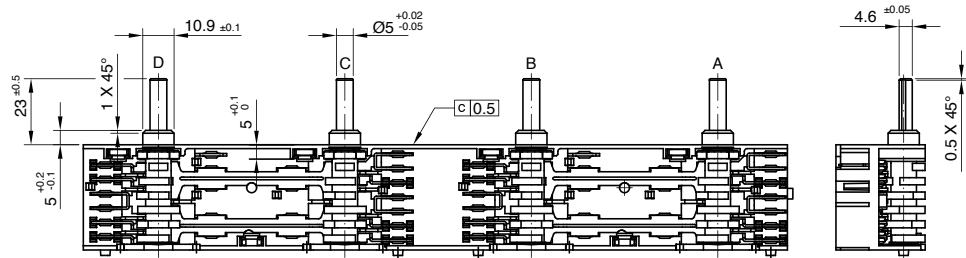



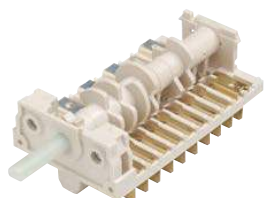

# CH

<b>TYPICAL APPLICATIONS</b>	Function selector switch
<b>WIRING DIAGRAMAS</b>	2 - 14 positions
<b>CYCLE No.</b>	Up to 30.000
<b>AMBIENT TEMPERATURE</b>	150 °C
<b>GWFI</b>	850 °C
<b>GWFI</b>	750 °C
<b>ADDITIONAL FEATURES</b>	<ul style="list-style-type: none"> <li>■ M4 screw mounting</li> <li>■ 26 contacts version available</li> </ul>



Thermostat version available

16 (6) A / 250 VAC - 30E3  
 16 (8) A / 250-125 VAC - 10E3  
 18 A / 250-125 VAC - 30E3  
 12 A / 400 VAC - 30E3  
 T150 °C  
 According to  
 EN61058-1 standard

3/4 HP / 125 VAC  
 18A / 250 VAC  
 16A / 250 VAC  
 T125 °C  
 According to  
 UL 1054

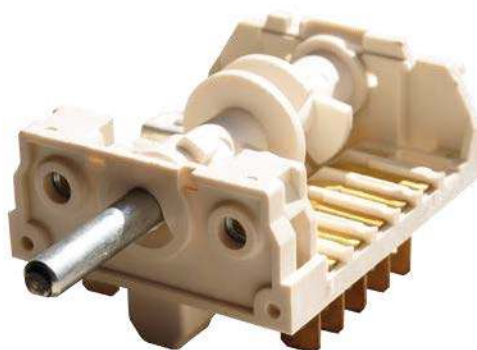

## DIMENSIONS

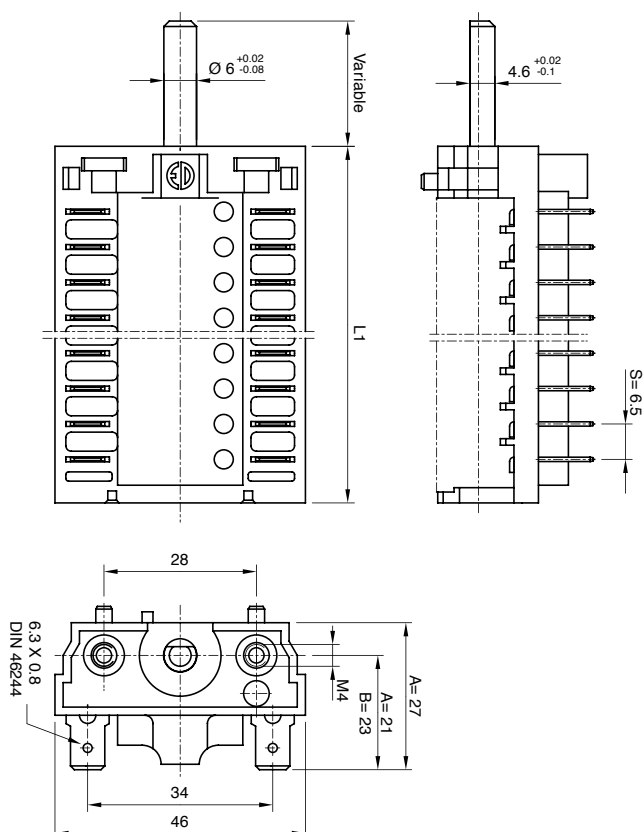

## CONTACT SEQUENCE

Basic Version					
Type	Contacts		L1		Version
	16(4)/250ac 6(2)/250ac	6(1.5)/250ac	S=7	S=6.5	
1-CH	1		29,5*		A
2-CH	2		25	36*	A
3-CH	3		32	33	A
4-CH	4		39	39.5	A, B
5-CH	5		46	46	A
6-CH	6		49,5		A
6-CH	6		53	52.5	A, B
7-CH	7			59	A, B
8-CH	8		67	65.5	A, B
9-CH	9			72	A
10-CH	10		81	78.5	A, B
11-CH	11		88	85	A, B
12-CH	12		95		A
13-CH	8	5	S=7	S=6	A
			97		

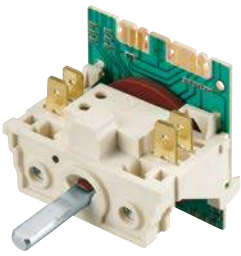

# 2CH with encoder

**TYPICAL APPLICATIONS** Electronic and electrical function selector

**WIRING DIAGRAMS** ■ On demand

**CYCLE No.** 30.000

**AMBIENT TEMPERATURE** 85 °C

**ADDITIONAL FEATURES** ■ Solution combining selector and encoder functions, that allows to improve flexibility and compactness



Solution combining selector and encoder functions, that allows to improve flexibility and compactness.

## Rating

16 (6) A / 250 VAC

10 (2) A / 400 VAC

18 A / 250 VAC

6 (4) A / 250 VAC

T 150 °C

According to

EN61058-1 standard

3/4 HP / 125 VAC

16 A / 250 VAC

13.8 A / 250 VAC

T 85 °C

According to

UL 1054

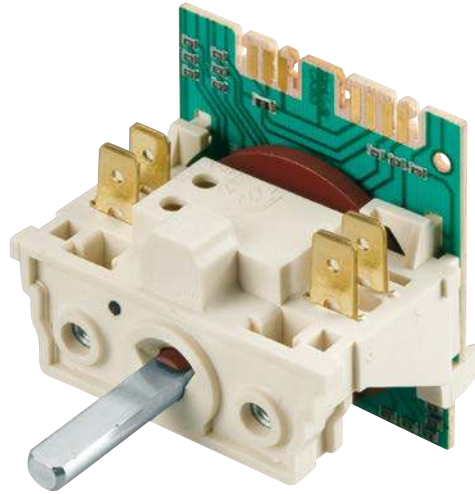

## DIMENSIONS

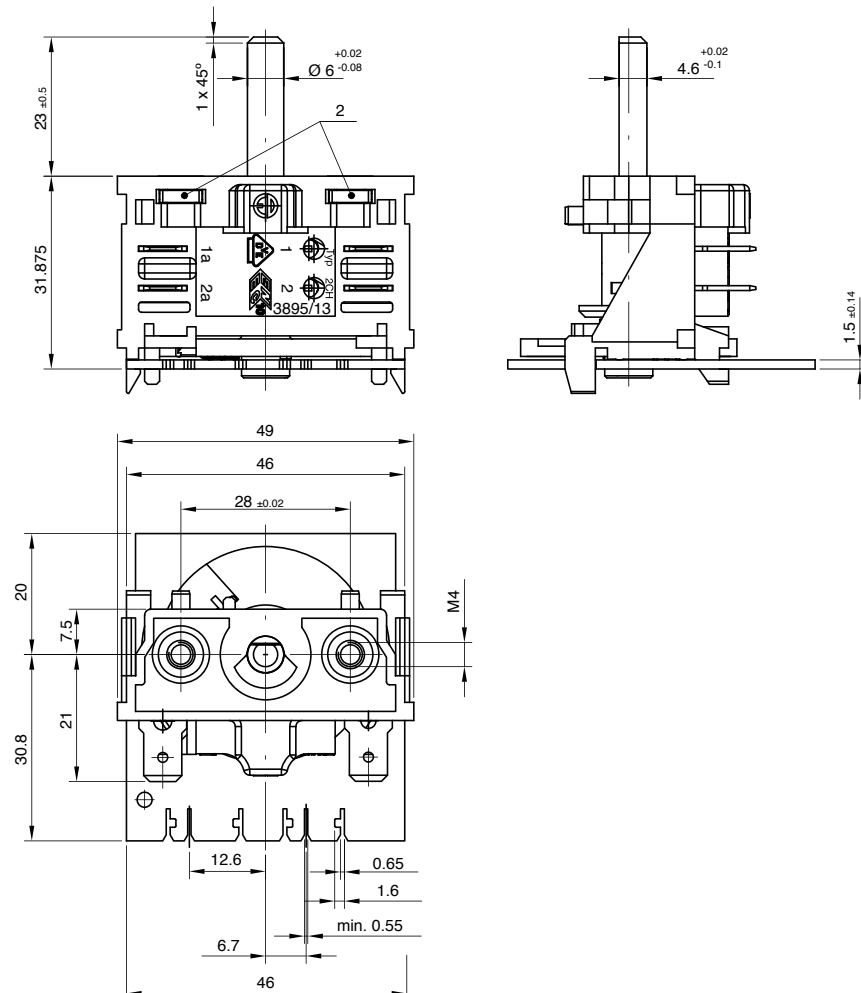

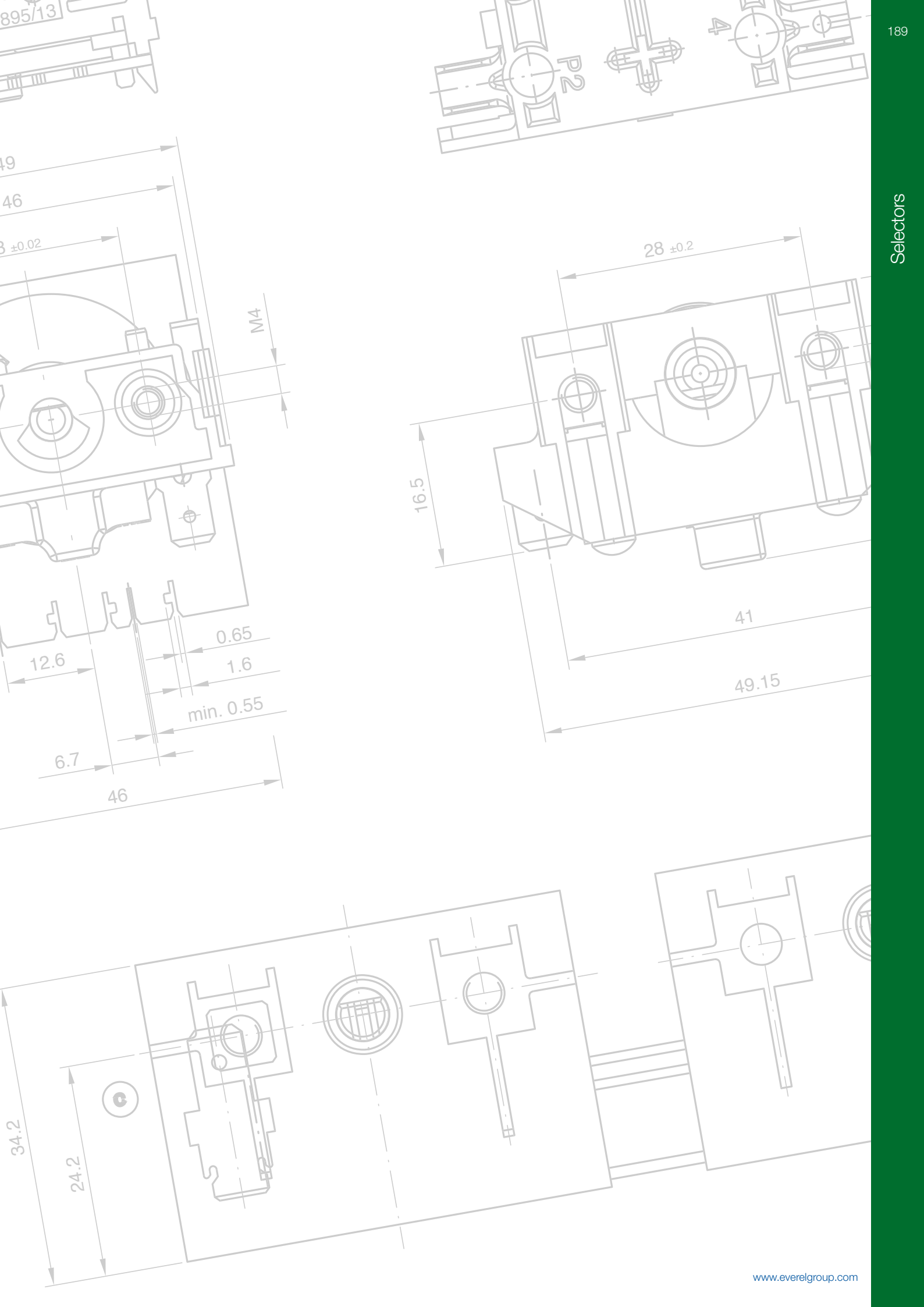



**Everel Group S.P.A.**

[Headquarter - Production Site]

Via Cavour, 9

37067 Valeggio sul Mincio (VR) - Italy

tel. +39 045 6313711

fax +39 045 6313730

**Dreefs GmbH**

[Production Site]

Ernst-Dreefs-Straße 7

96364 Marktrodach - Germany

tel. +49 9261 9610

fax +49 9261 961248

**Everel Romania S.r.l.**

[Production Site]

Calea Timisorii 109

Lipova - Arad - Romania

tel. +40 257 563087

fax +40 257 563086

[www.everelgroup.com](http://www.everelgroup.com)

