



B4MASK



TYPICAL APPLICATIONS

Outdoor electrical equipments, pumps, high pressure cleaners

FUNCTIONS

- SPST
- DPST, illuminated or not
- DPCO

PROTECTION DEGREE

IP 65

CYCLE No.

50.000

CUT OUT

30x22 mm

AMBIENT TEMPERATURE

120 °C

GWT

850 °C

GWT NO FLAME (<2 sec)

750 °C on demand

B 4 M A S K

DRAWING



TERMINAL

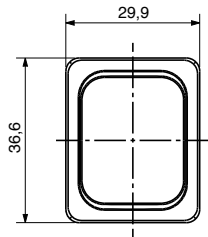
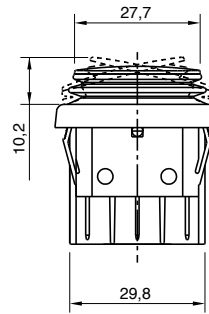
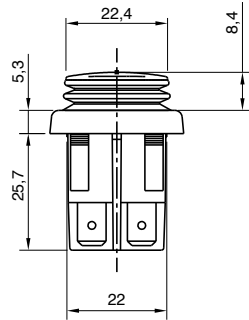

→ Available in **Gloss** or **Mat**

1 Gloss version

3 Mat version

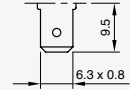

4 Gloss version

5 Mat version

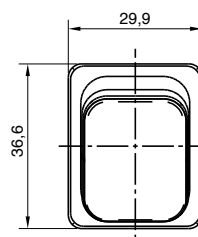
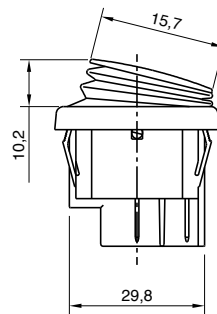
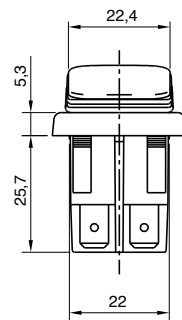
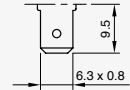

→ Available in **Gloss** or **Mat**

L Gloss version

P Mat version

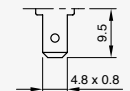

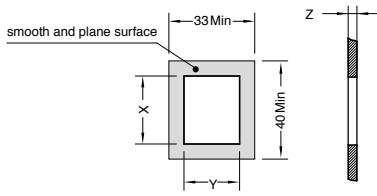

Z	Y	X
0,75 ... 1,25	22,0	$\begin{matrix} +0,2 \\ 0 \end{matrix}$ 30,2 ±0,1
1,25 ... 2,0	22,0	$\begin{matrix} +0,2 \\ 0 \end{matrix}$ 30,6 ±0,1
2,0 ... 3,0	22,0	$\begin{matrix} +0,2 \\ 0 \end{matrix}$ 30,8 ±0,1

B 4 M A S K □ □ □ □ □ □ □ **0 0 0**

TERMINAL FUNCTION RATING RUBBER COLOUR ROCKER COLOUR MARKING COLOUR MARKING

FUNCTION	RATING	RUBBER COLOUR	ROCKER COLOUR	MARKING COLOUR	MARKING
<p>1</p>	<p>C</p> <p>Function 9</p> <p>16 (6) A / 250 VAC 10 (4) A / 250 VAC - 5E4 T120/55 °C EN 61058</p>	<p>1 ■</p> <p>black</p>	<p>1 ■</p> <p>black</p> <p>2 ■</p> <p>white</p> <p>ILLUMINATED ✨</p> <p>G ■</p> <p>red</p> <p>E ■</p> <p>green</p> <p>L ■</p> <p>white</p> <p>F ■</p> <p>blue</p> <p>BRIGHT ✨</p> <p>A ■</p> <p>orange</p> <p>V ■</p> <p>green</p> <p>X ■ ?</p> <p>custom</p>	<p>0</p> <p>none</p> <p>1 ■</p> <p>black</p> <p>2 ■</p> <p>white</p> <p>X ?</p> <p>custom</p>	<p>0 </p> <p>1 ○ </p> <p>A ○ </p> <p>9 - ○ =</p> <p>X ?</p>
<p>2</p>	<p>20 A / 125 VAC 16 A / 250 VAC 1/3 HP - 125 VAC 3/4 HP - 250 VAC T105 °C UL 1054 CSA C22.2</p>				
<p>8</p>	<p>E</p> <p>Function 1</p> <p>16 (8) A / 250 VAC 12 (10) A / 250 VAC - 5E4 T120 / 55 °C EN 61058</p>				
<p>9 Terminal 1 - 3</p>	<p>20 A / 125 VAC 16 A / 250 VAC 1/3 HP - 125 VAC 3/4 HP - 250 VAC T105 °C UL 1054 CSA C22.2</p>				
	<p>N</p> <p>Function 2 - 8</p> <p>16 (8) A / 250 VAC 12 (10) A / 250 VAC - 5E4 T120/55 °C EN 61058</p> <p>20 A / 125 VAC 16 A / 250 VAC 3/4 HP - 125 / 250 VAC T105 °C UL 1054 CSA C22.2</p>				
	<p>S</p> <p>Function 2 - 8</p> <p>20 (10) A / 250 VAC 14 (14) A / 250 VAC - 5E4 T120/55 °C EN 61058</p> <p>25 A / 125 VAC 16 A / 250 VAC 3/4 HP - 125 / 250 VAC T105 °C UL 1054 CSA C22.2</p>				