

SXLR



TYPICAL APPLICATIONS	Steam cleaners
FUNCTIONS	<ul style="list-style-type: none"> ■ SPST, illuminated ■ DPST, illuminated or not
PROTECTION DEGREE	IP 65
CYCLE No.	50.000
CUT OUT	ø 25 mm
AMBIENT TEMPERATURE	125 °C
GWT	850 °C
GWT NO FLAME (<2 sec)	750 °C on demand



DRAWING



TERMINAL

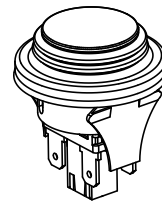
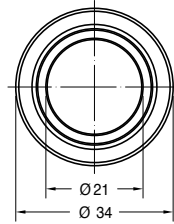
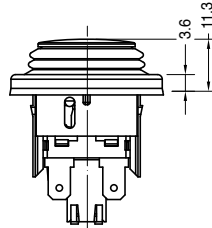
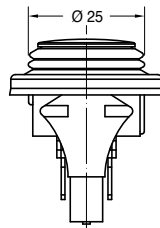

2

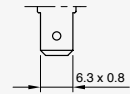

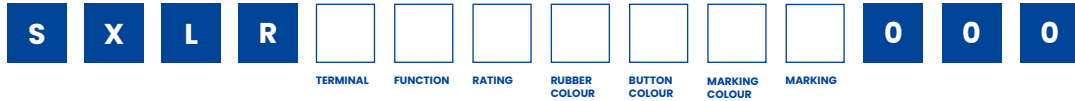
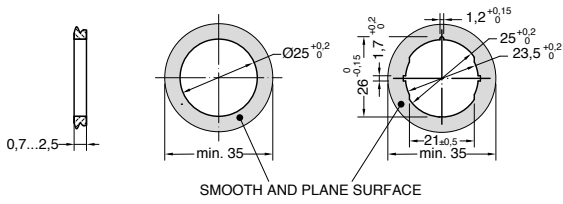

	FUNCTION	RATING	RUBBER COLOUR	BUTTON COLOUR	MARKING COLOUR	MARKING	
2		C 16 (4) A / 250 VAC 10 (2) A / 250 VAC - 5E4 T125 °C EN 61058 12 A - 125 / 250 VAC 1/4 HP - 125 VAC 1/2 HP - 250 VAC T100 °C UL 1054	1 black X custom	M white N black ILLUMINATED	0 none 1 black 2 white X custom	0	
6			C 16 (4) A / 250 VAC 10 (2) A / 250 VAC - 5E4 T125 °C EN 61058 12 A - 125 / 250 VAC 1/4 HP - 125 VAC 1/2 HP - 250 VAC T100 °C UL 1054	1 black X custom	G red H orange E green L white F blue X custom	0 none 1 black 2 white X custom	0
8				C 16 (4) A / 250 VAC 10 (2) A / 250 VAC - 5E4 T125 °C EN 61058 12 A - 125 / 250 VAC 1/4 HP - 125 VAC 1/2 HP - 250 VAC T100 °C UL 1054	1 black X custom	G red H orange E green L white F blue X custom	0 none 1 black 2 white X custom